

# Equal Angles

Dimensions and properties to BS EN 10056-1: 1999

200 x 200 x 24 – 90 x 90 x 6

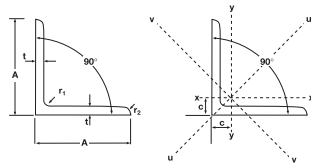

\*These sizes are in addition to our standard range to BS EN 10056-1: 1999 Specification

Designation Serial Size A x A x t mm x mm x mm	Mass per metre kg/m	Root Radius $r_1$ mm	Toe Radius $r_2$ m	Area of Section cm <sup>2</sup>	Distance of centre of gravity C cm	Second Moment of Area			Radius of Gyration			Elastic Modulus axis x-x, y-y cm <sup>4</sup> m <sup>4</sup>	Tortional Constant J cm <sup>4</sup>	Equivalent Slenderness Coefficient $\phi_a$
						Axis x-x, y-y cm <sup>4</sup>	Axis u-u cm <sup>4</sup>	Axis v-v cm <sup>4</sup>	Axis x-x, y-y cm <sup>4</sup>	Axis u-u cm <sup>4</sup>	Axis v-v cm <sup>4</sup>			
200 x 200 x 24	71.1	18	9.0	90.6	5.84	3331	5280	1380	6.06	7.64	3.90	235	182	2.50
200 x 200 x 20	59.9	18	9.0	76.3	5.68	2851	4530	1170	6.11	7.70	3.92	199	107	3.05
200 x 200 x 18	54.2	18	9.0	69.1	5.60	2600	4150	1050	6.13	7.75	3.90	181	78.9	3.43
200 x 200 x 16	48.5	18	9.0	61.8	5.52	2342	3720	960	6.16	7.76	3.94	162	56.1	3.85
*150 x 150 x 18	40.1	16	8.0	51.0	4.37	1050	1680	440	4.54	5.73	2.92	98.8	58.6	2.48
150 x 150 x 15	33.8	16	8.0	43.0	4.25	898	1430	370	4.57	5.76	2.93	83.5	34.6	3.01
150 x 150 x 12	27.3	16	8.0	34.8	4.12	737	1170	303	4.60	5.80	2.95	67.8	18.2	3.77
150 x 150 x 10	23.0	16	8.0	29.3	4.03	624	990	258	4.62	5.82	2.97	56.9	10.8	4.51
*120 x 120 x 15	26.6	13	6.5	33.9	3.51	445	710	186	3.62	4.57	2.34	52.4	27.0	2.37
120 x 120 x 12	21.6	13	6.5	27.5	3.40	368	584	152	3.65	4.60	2.35	42.7	14.2	2.99
120 x 120 x 10	18.2	13	6.5	23.2	3.31	313	497	129	3.67	4.63	2.36	36.0	8.41	3.61
*120 x 120 x 8	14.7	13	6.5	18.7	3.23	256	411	107	3.69	4.67	2.38	29.1	4.44	4.56
*100 x 100 x 15	21.9	12	6.0	27.9	3.02	249	395	105	2.98	3.76	1.94	35.6	22.3	1.92
100 x 100 x 12	17.8	12	6.0	22.7	2.90	207	328	85.7	3.02	3.80	1.94	29.1	11.8	2.44
100 x 100 x 10	15.0	12	6.0	19.2	2.82	177	280	73	3.04	3.83	1.95	24.6	6.97	2.94

100 x 100 x 8	12.2	12	6.0	15.5	2.74	145	230	59.9	3.06	3.85	1.96	20.0	3.68	3.70
*90 x 90 x 12	15.9	11	5.5	20.3	2.66	148	235	62	2.70	3.40	1.75	23.4	10.46	2.17
90 x 90 x 10	13.4	11	5.5	17.1	2.58	127	201	52.6	2.72	3.42	1.75	19.8	6.20	2.64
90 x 90 x 8	10.9	11	5.5	13.9	2.50	104	166	43.1	2.74	3.45	1.76	16.1	3.28	3.33
90 x 90 x 6	9.6	11	5.5	12.2	2.45	92.6	147	38.3	2.75	3.46	1.77	14.1	2.24	3.80

